



Amendment to Solicitation

Amendment No. 04	
Page 1	of 18

1. Solicitation Amendment Pursuant To

a. Solicitation No. 162640-08-A-0206	b. Date of Solicitation 7/9/2008	c. Contract No.	d. Begin Contract Term	e. End Contract Term
f. For Mail Service In or Between	City & State		City & State	
2. Bidder/Offeror Name and Address (Print or Type)			3. Issued By Michael Loghnanne Great Lakes FSO 62 Stratford Dr Bloomington, IL 60117-7000	
			4. Date Issued: 8/5/2008	

5. Description of Amendment Modification

This amendment provides the missing USPS Pricing Forms and Contacts for; Signage, Baker's Intergrated Work Station(Full Service Counters Pricing), and Scissors Lift.

- Signage (10 pages)
- Full Service Counters Pricing (6 pages)
- Scissors Lift Pricing (1 page)

Except as provided herein, all terms and conditions of the document referenced in Block 1 remain unchanged and in full force and effect.

6. The above numbered solicitation is amended as set forth in Block 5.

NOTE: Offerors must acknowledge receipt of this amendment prior to the date and time specified in the solicitation by one of the following methods by:

- a. Signing and returning one copy of the amendment;
- b. Acknowledging receipt of this amendment on each copy of the bid/proposal submitted; or
- c. Submitting separate letter or telegram which includes a reference to the solicitation and amendment numbers.

FAILURE OF YOUR ACKNOWLEDGEMENT TO BE RECEIVED AT THE PLACE SPECIFIED IN THE SOLICITATION PRIOR TO THE DATE AND TIME SPECIFIED FOR RECEIPT OF BIDS/PROPOSALS MAY RESULT IN REJECTION OF YOUR BID/PROPOSAL.

If, by virtue of this amendment, you desire to change a bid/proposal already submitted, such change may be made by telegram or letter provided such telegram or letter makes reference to the solicitation and amendment numbers, and is received prior to the date and time specified.

If this box is checked, the date and time specified for receipt of the bid/proposal is extended to:

_____ Date _____ Time

7. Bidder/Offeror	8. U.S. Postal Service
The receipt of this Amendment to Solicitation is hereby acknowledged:	The U.S. Postal Service has hereby issued this Amendment to Solicitation:
_____ (Signature of bidder/offeror)	Bradford Meador 08/05/2008 (Name & Signature of Contracting Officer) (Date)
_____ (Name and title of bidder/offeror)	Manager, Real Estate (Title of Contracting Officer)

SIGNAGE PRICING FORM: GENERAL INFORMATION

Instructions: (Form may be completed manually on a hard copy or by computer as an Excel spreadsheet.)

1. Direct Vendor:

Transworld Signs Inc.
555 Hall Avenue E.
P.O. Box 236
Renfrew, Ontario K7V 4A3
Ph: 888-830-8030
Fax: 888-254-0043

2. Include a printed copy of the completed Signage Pricing Form in the solicitation. If the USPS is ordering signs (typically interior replacement signs) send a completed form to the vendor
3. General Information Form must be completely filled out before sign order is placed with the direct vendor.
4. Include Direct Vendor on solicitation package distribution list.
5. The General Contractor is responsible for ordering, installation, and payment for the signage.
6. The General Contractor is responsible for coordinating signage pricing with Transworld Signs, inclusive of FOB origin shipping costs.

SIGNAGE PRICING FORM: GENERAL INFORMATION

FMS Project Number

Finance Number

Sub-location Number

GENERAL CONTRACTOR / ORDER AGENT INFORMATION:

Print Name

Required Delivery Date

Company Name

Street

City, State, Zip Code

TEL: Area code + telephone number

FAX: Area code + fax number

Special Instructions

SHIP TO: (for sign installation)

Attention Line: Post Office or Station Name

PHYSICAL SITE LOCATION:

Attention

United States Postal Service

Street, Room

Name of Post Office/ Postal Facility

Street, Room

City, State, Zip Code

City, State, Zip Code

TEL: Area code + telephone number

TEL: Area code + telephone number

FAX: Area code + fax number

FAX: Area code + fax number

SIGNAGE PRICING FORM: EXTERIOR RETAIL SIGNS

FMS Project Number

Finance Number

Instructions:

1. Select the Standard Building Design name for standard sign quantities.
2. Additional signs may be entered, as required, by changing the quantity (Qty) of specific items.
3. Click on the "Calculate" button. Use "Clear Form" button for mistakes, or to start over.
4. Use the "Print Form" button to print the form, without unit prices, for inclusion in project solicitation.
5. The most recent release of this order form must be used, to ensure accurate pricing.
6. Standard sign manufacturing time is 25 business days, Non-standard signs require a period of 45 business days for manufacturing. All signs require an additional 5 business days for shipping.

Standard Building Design

<p>SSBD</p> <p><input type="radio"/> SSBD 10</p> <p><input type="radio"/> SSBD 15</p> <p><input checked="" type="radio"/> SSBD 20</p> <p><input type="radio"/> SSBD 25</p> <p><input type="radio"/> SSBD 30</p> <p><input type="radio"/> SSBD 40</p> <p><input type="radio"/> SSBD 50</p> <p><input type="radio"/> SSBD 65A</p> <p><input type="radio"/> SSBD 65B</p> <p><input type="radio"/> SSBD 80A</p> <p><input type="radio"/> SSBD 80B</p> <p><input type="radio"/> SSBD 100A</p> <p><input type="radio"/> SSBD 100B</p>	<p>MSBD</p> <p><input type="radio"/> MSBD R1</p> <p><input type="radio"/> MSBD R2</p> <p><input type="radio"/> MSBD R3</p>	<p>MODULAR</p> <p><input type="radio"/> MODULAR</p>
---	--	---

Selected Standard Design:	SSBD 20	Estimated Cost \$5,428.00
---------------------------	---------	---------------------------

PSIN	DESCRIPTION	UNIT COST	QUANTITY
RA18	18'-0" Illuminated Pylon	\$4,259.00	1
RA20	20'-0" Illuminated Pylon	\$5,198.00	0
RA25*	25'-0" Illuminated Pylon	\$6,077.00	0
RB6*	6'-6" Illuminated Vert (Sq.) Monument	\$1,933.00	0
RB6-NI*	6'-6" Non Illuminated Vert (Sq.) Monument	\$1,791.00	0
RB9*	9'-6" Illuminated Vert (Sq.) Monument	\$2,898.00	0
RB9-NI*	9'-6" Non Illuminated Vert (Sq.) Monument	\$3,992.00	0
RBR5*	5'-0" Illuminated Horizontal Monument	\$2,452.00	0
RBR5-NI*	5'-0" Non Illum. Horiz. Monument	\$2,029.00	0
RBR7*	6'-8" Illuminated Horizontal Monument	\$3,119.00	0
RBR7-NI*	6'-8" Non Illuminated Horizontal Monument	\$2,386.00	0
RBR8*	8'-4" Illuminated Horizontal Monument	\$3,959.00	0
RBR8-NI*	8'-4" Non Illuminated Horizontal Monument	\$3,373.00	0
RCR32	2'-8" Illuminated Horizontal Cabinet	\$1,011.00	1
RCR32-NI*	2'-8" Non Illuminated Horizontal Cabinet	\$672.00	0
RCR42	3'-6" Illuminated Horizontal Cabinet	\$1,411.00	0
RCR42-NI*	3'-6" Non Illuminated Horizontal Cabinet	\$844.00	0
RCR64	5'-4" Illuminated Horizontal Cabinet	\$2,722.00	0

SIGNAGE PRICING FORM: EXTERIOR RETAIL SIGNS

FMS Project Number	Finance Number

RCR64-NI*	5'-4" Non Illuminated Horizontal Cabinet	\$1,383.00	0
RCS40	3'-4" Illuminated Vert (Sq.) Cabinet	\$898.00	0
RCS40-NI*	3'-4" Non Illuminated Vert (Sq.) Cabinet	\$445.00	0
RCS64*	5'-4" Illuminated Vert (Sq.) Cabinet	\$1,311.00	0
RCS64-NI*	5'-4" Non Illuminated Vert (Sq.) Cabinet	\$749.00	0
RD24-10	10'-3 3/8" Long Illuminated 24" Striping	\$1,133.00	0
RD24-15	15'-7" Long Illuminated 24" Striping	\$1,636.00	0
RD24-20	20'-0" Long Illuminated 24" Striping	\$2,143.00	0
RD24-6	6'-0" Long Illuminated 24" Striping	\$867.00	0
RN1	Door Vinyls (Hours)	\$27.00	1
RN2*	Door Vinyls (Station & Hours)	\$19.00	0
RN3	Door/Window Vinyls (Station)	\$22.00	1
RN5*	Camera Warning	\$25.00	0
RN5P*	Camera Warning Aluminum Plaque	\$98.00	0
RS1	2'-6" Plaque W/ 2" Caps	\$109.00	1
RS2*	3'-9" Plaque W/ 3" Caps	\$142.00	0
RS3*	5'-0" Plaque W/ 4" Caps	\$214.00	0

Note: Estimated sign costs are for manufactured signs only, Installation is not included

Note: The General Contractor is responsible for coordinating signage pricing with Transworld Signs, inclusive of FOB origin shipping costs.

* Indicates a Non-standard sign that requires a manufacturing period of 45 Business Days

SIGNAGE PRICING FORM: EXTERIOR RETAIL SIGNS

FMS Project Number

Finance Number

Item

Description

RN1,RN2,RN3

Retail Station

Station Name (Main Post Office, Station, Branch)

ID Plaque

City, State

Full Service Hours

Monday-Friday AM- AM: PM- PM

or

Monday-Friday AM- AM: PM- PM

Saturday AM- AM: PM- PM

Sunday & Holidays Closed

Self Service Hours:

Monday-Friday AM- AM: PM- PM

or

Monday-Friday AM- AM: PM- PM

Saturday AM- AM: PM- PM

Sunday & Holidays Closed

RS1,RS2,RS3

Retail Station

Station Name (Main Post Office, Station, Branch)

ID Plaque

City, State

Note: Information on this sheet must be completed for fabrication of RN and RS signs.

SIGNAGE PRICING FORM: INTERIOR RETAIL SIGNS

FMS Project Number

Finance Number

Instructions:

1. Select the Standard Building Design name for standard sign quantities.
2. Additional signs may be entered, as required, by changing the quantity (Qty) of specific items.
3. Click on the "Calculate" button. Use "Clear Form" button for mistakes, or to start over.
4. Use the "Print Form" button to print the form, without unit prices, for inclusion in project solicitation.
5. The most recent release of this order form must be used, to ensure accurate pricing.
6. Standard sign manufacturing time is 25 business days, Non-standard signs require a period of 45 business days for manufacturing. All signs require an additional 5 business days for shipping.

Standard Building Design

<p>SSBD</p> <p><input type="radio"/> SSBD 10</p> <p><input type="radio"/> SSBD 15</p> <p><input checked="" type="radio"/> SSBD 20</p> <p><input type="radio"/> SSBD 25</p> <p><input type="radio"/> SSBD 30</p> <p><input type="radio"/> SSBD 40</p> <p><input type="radio"/> SSBD 50</p> <p><input type="radio"/> SSBD 65A</p> <p><input type="radio"/> SSBD 65B</p> <p><input type="radio"/> SSBD 80A</p> <p><input type="radio"/> SSBD 80B</p> <p><input type="radio"/> SSBD 100A</p> <p><input type="radio"/> SSBD 100B</p>	<p>MSBD</p> <p><input type="radio"/> MSBD R1</p> <p><input type="radio"/> MSBD R2</p> <p><input type="radio"/> MSBD R3</p>	<p>MODULAR</p> <p><input type="radio"/> MODULAR</p>
--	---	--

Selected Standard Design:	SSBD 20	Estimated Cost \$2,258.00
---------------------------	---------	---------------------------

PSIN	DESCRIPTION	UNIT COST	QUANTITY
J1-B1	Mandatory Poster Frames	\$167.00	1
J1-B2	Missing Children-Wanted Parents Frames	\$170.00	1
J2-A1	8ft Panel of 17-3/4" Interior Striping	\$168.00	0
J2-B1	8ft Panel of 11-3/4" interior Striping	\$128.00	7
J3-A1	5" White Sintra Letters / Self Service	\$59.00	0
J3-A2	5" Blue Sintra Letters / Self Service	\$59.00	0
J3-A3	3-1/4" White Sintra Letters / Self Service	\$59.00	1
J3-A4	3-1/4" Blue Sintra Letters / Self Service	\$59.00	0
J3-B1	5" White Sintra Letters / Rent-a-Box	\$52.00	0
J3-B2	5" Blue Sintra Letters / Rent-a-Box	\$52.00	0
J3-B3	3-1/4" White Sintra Letters / Rent-a-Box	\$52.00	1
J3-B4	3-1/4" Blue Sintra Letters / Rent-a-Box	\$52.00	0
J3-C1	5" White Sintra Letters / Copier	\$40.00	0
J3-C2	5" Blue Sintra Letters / Copier	\$40.00	0
J3-C3	3-1/4" White Sintra Letters / Copier	\$40.00	0
J3-C4	3-1/4" Blue Sintra Letters / Copier	\$38.00	0
J3-D1	5" White Sintra Letters / Passports	\$59.00	0
J3-D2	5" Blue Sintra Letters / Passports	\$59.00	0
J3-D3	3-1/4" White Sintra Letters / Passports	\$59.00	0

SIGNAGE PRICING FORM: INTERIOR RETAIL SIGNS

FMS Project Number		Finance Number

J3-D4	3-1/4" Blue Sintra Letters / Passports	\$59.00	0
J3-E1	5" White Sintra Letters / Meter Setting	\$63.00	0
J3-E2	5" Blue Sintra Letters / Meter Setting	\$63.00	0
J3-E3	3-1/4" White Sintra Letters / Meter Setting	\$63.00	0
J3-E4	3-1/4" Blue Sintra Letters / Meter Setting	\$63.00	0
J3-F1	5" White Sintra Letters / Conference	\$56.00	0
J3-F2	5" Blue Sintra Letters / Conference	\$56.00	0
J3-F3	3-1/4" White Sintra Letters / Conference	\$56.00	0
J3-F4	3-1/4" Blue Sintra Letters / Conference	\$56.00	0
J4-A1	Action Step 1 Plaque-Weigh it/Wall attached	\$41.00	0
J4-B1	Action Step 2 Plaque-Stamp it / Wall attached	\$41.00	0
J4-C1	Action Step 3 Plaque-Mail it / Wall attached	\$41.00	0
J5-A1	Weigh it Plaque / Wall attached	\$41.00	0
J5-B1	Stamp it Plaque / Wall attached	\$41.00	0
J5-C1	Mail it Plaque / Wall attached	\$41.00	0
J6-A1	How to Weigh-Triner Scale / Wall Attached	\$60.00	0
J6-A2	How to Weigh-Triner Scale / Fixture Surface Mounted	\$60.00	0
J6-B1	How to Weigh-Ascom Scale / Wall Attached	\$68.00	0
J6-B2	How to Weigh-Ascom Scale / Fixture Surface Mounted	\$68.00	0
J6-C1	How to Weigh-Unisys Scale / Wall Attached	\$68.00	0
J6-C2	How to Weigh-Unisys Scale / Fixture Surface Mounted	\$68.00	0
J7-A1	Mail Drop ID Plaque / Metered Letters	\$11.00	0
J7-A2	Mail Drop ID Plaque / Stamped Letters	\$11.00	0
J7-A3	Mail Drop ID Plaque / Metered	\$10.00	0
J7-A4	Mail Drop ID Plaque / Mail	\$11.00	1
J7-A5	Mail Drop ID Plaque / Local	\$11.00	1
J7-A6	Mail Drop ID Plaque / Out of Town	\$11.00	1
J7-A7	Mail Drop ID Plaque / Parcels	\$10.00	0
J7-A8	Mail Drop ID Plaque / Priority	\$10.00	0
J7-A9	Mail Drop ID Plaque / Express Mail	\$11.00	1
J7-A10	Mail Drop ID Plaque / Global Priority	\$11.00	0
J7-A11	Mail Drop ID Plaque / International Express	\$10.00	0
J7-B1	Mail Drop Security Plaque	\$11.00	2
J7-C1	Collection Times Plaque w/ Replacement Kit	\$328.00	1
J8-A1	Box Mail Availability Plaque w/ Replacement Kit	\$136.00	1
J8-B1	Post Office Box Info. Plaque w/ Replacement Kit	\$328.00	1
J9-A1	Ring Bell for Service Wall Plaque	\$8.00	1
J10-A1	Push/Pull Entry Door Graphics / Set of 4	\$24.00	2
J11-A1	Next Station Please/Network Plaque	\$19.00	0
J12-A1	2'-10-5/8" x 1'-11-5/8" Illuminated Menu Board Display	\$230.00	0
APC Unit	APC, backdrop Unit, Aluminum	\$1,264.00	0
APC Unit w/Spacer	APC, backdrop Unit, Aluminum w/Black Wall Spacer Kit	\$1,467.00	0
APC Adapter	APC Adapter, Gooseneck, Overhead Wiring	\$24.00	0

Note: Estimated sign costs are for manufactured signs only, Installation is not included

Note: The General Contractor is responsible for coordinating signage pricing with Transworld Signs, inclusive of FOB origin shipping costs.

* Indicates a Non-standard sign that requires a manufacturing period of 45 Business Days

SIGNAGE PRICING FORM: DIRECTIONAL & REGULATORY SIGNS

FMS Project Number

Finance Number

Instructions:

1. Select the Standard Building Design name for standard sign quantities.
2. Additional signs may be entered, as required, by changing the quantity (Qty) of specific items.
3. Click on the "Calculate" button. Use "Clear Form" button for mistakes, or to start over.
4. Use the "Print Form" button to print the form, without unit prices, for inclusion in project solicitation.
5. The most recent release of this order form must be used, to ensure accurate pricing.
5. Standard sign manufacturing time is 25 business days, Non-standard signs require a period of 45 business days for manufacturing. All signs require an additional 5 business days for shipping.

Standard Building Design

<p>SSBD</p> <p><input type="radio"/> SSBD 10</p> <p><input type="radio"/> SSBD 15</p> <p><input checked="" type="radio"/> SSBD 20</p> <p><input type="radio"/> SSBD 25</p> <p><input type="radio"/> SSBD 30</p> <p><input type="radio"/> SSBD 40</p> <p><input type="radio"/> SSBD 50</p> <p><input type="radio"/> SSBD 65A</p> <p><input type="radio"/> SSBD 65B</p> <p><input type="radio"/> SSBD 80A</p> <p><input type="radio"/> SSBD 80B</p> <p><input type="radio"/> SSBD 100A</p> <p><input type="radio"/> SSBD 100B</p>	<p>RETAIL MSBD</p> <p><input type="radio"/> MSBD R1</p> <p><input type="radio"/> MSBD R2</p> <p><input type="radio"/> MSBD R3</p>	<p>CORPORATE SSBD</p> <p><input type="radio"/> SSBD</p>
	<p>RETAIL MODULAR</p> <p><input type="radio"/> Modular</p>	<p>CORPORATE MSBD</p> <p><input type="radio"/> MSBD</p>

Selected Standard Design:	SSBD 20	Estimated Cost \$136.00
---------------------------	---------	----------------------------

PSIN	DESCRIPTION	UNIT COST	QUANTITY
K-6	6'-0" Directional Sign	\$562.00	0
L-1a	12"x5'-0" Regulatory Pole Sign	\$68.00	2
L-2a*	14"x6'-6" Regulatory Pole Sign	\$77.00	0
L-3a*	18"x6'-6" Regulatory Pole Sign	\$86.00	0
L-1b*	12"x13" Regulatory Wall Sign	\$41.00	0
L-2b*	14"x15" Regulatory Wall Sign	\$43.00	0
L-3b*	18"x20" Regulatory Wall Sign	\$52.00	0
L-1c*	12"x13" Regulatory Flag Sign	\$41.00	0
L-2c*	14"x15" Regulatory Flag Sign	\$47.00	0
L-3c*	18"x20" Regulatory Flag Sign	\$55.00	0
L-1d*	12"x13" Regulatory Fence Sign	\$47.00	0
L-2d*	14"x15" Regulatory Fence Sign	\$49.00	0
L-3d*	18"x20" Regulatory Fence Sign	\$58.00	0
M-1*	Large Fence Regulatory Sign	\$118.00	0
M-2*	Medium Fence Regulatory Sign	\$93.00	0
M-3*	Small Fence Regulatory Sign	\$72.00	0
M-4*	Small Fence Regulatory Sign / Red & White	\$93.00	0

Note: Estimated sign costs are for manufactured signs only, Installation is not included

Note: The General Contractor is responsible for coordinating signage pricing with Transworld Signs, inclusive of FOB origin shipping costs.

* Indicates a Non-standard sign that requires a manufacturing period of 45 Business Days

SIGNAGE PRICING FORM: DIRECTIONAL & REGULATORY SIGNS

FMS Project Number

Finance Number

K6

6-0" Directional Sign

(^,<,> may be used for arrows)

Approved Legends:

- Enter
- Enter Only
- Exit
- Exit Only
- Parking
- Additional Parking
- Employee Entrance
- Mail Drops
- Deliveries
- Business Mail Entry Unit
- Admin.

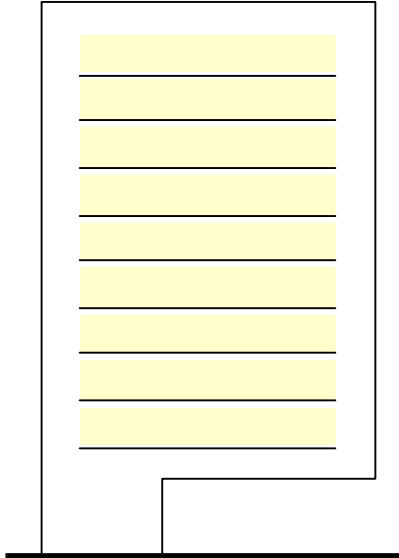

Side A

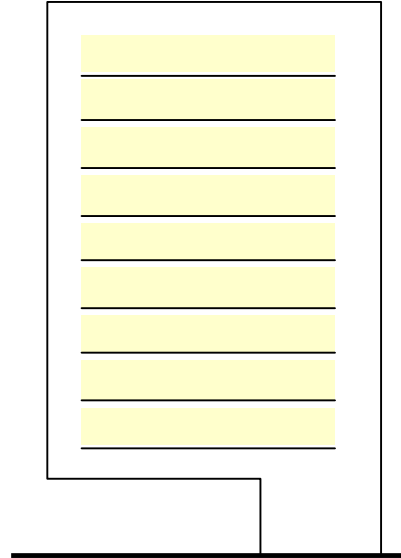

Side B

6-0" Directional Sign

(^,<,> may be used for arrows)

Approved Legends:

- Enter
- Enter Only
- Exit
- Exit Only
- Parking
- Additional Parking
- Employee Entrance
- Mail Drops
- Deliveries
- Business Mail Entry Unit
- Admin.

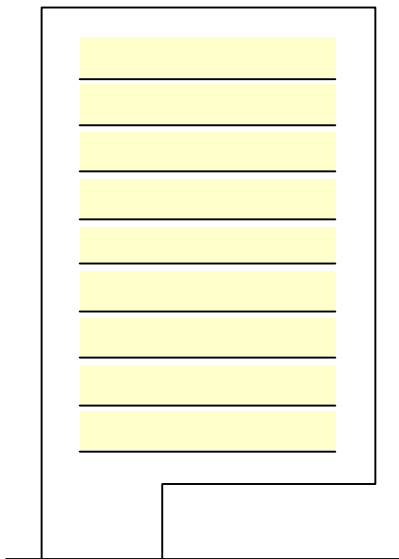

Side A

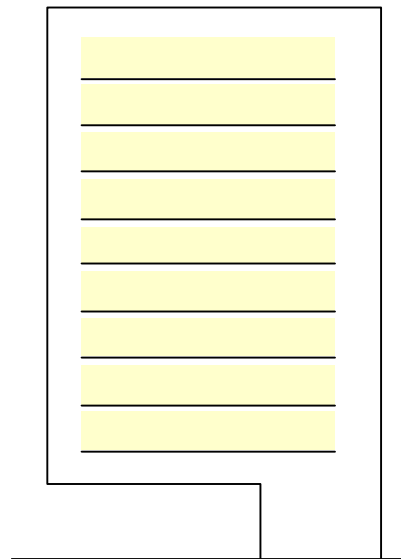

Side B

Note: Information on this sheet must be completed for fabrication of directional and regulatory signs.

SIGNAGE PRICING FORM: DIRECTIONAL & REGULATORY SIGNS

FMS Project Number

Finance Number

K6

6-0" Directional Sign

(^,<,> may be used for arrows)

Approved Legends:

- Enter
- Enter Only
- Exit
- Exit Only
- Parking
- Additional Parking
- Employee Entrance
- Mail Drops
- Deliveries
- Business Mail Entry Unit
- Admin.



Side A

Side B

Regulatory Signs

Indicate PSIN number for regulatory signs

Standard Sign Copy

Custom Sign Copy

Indicate PSIN number for regulatory signs

Standard Sign Copy

Custom Sign Copy

Indicate PSIN number for regulatory signs

Standard Sign Copy

Custom Sign Copy

Approved Legends:

- Authorized Parking Only
- Customer Parking
- Employee Parking
- Enter
- Exit Only
- Handicap Accessible (with handicap glyph)
- Postmaster Parking Only
- Reserved Parking
- Reserved Parking for Postal Customers Only

- L-1a
- L-2a
- L-3a
- L-1b
- L-2b
- L-3b
- L-1c
- L-2c
- L-3c
- L-1d
- L-2d
- L-3d

*** Information on this sheet must be completed for fabrication of directional and regulatory signs.**

FULL SERVICE COUNTERS PRICING

Instructions:

1. DIRECT VENDOR:

Baker Manufacturing Company, Inc.
P.O. Box 4120
Pineville, LA 71361-4120
888-512-7036 - Customer Service

Point of Contact: Stephanie Crooks or Jamie Paul

2. Include Direct Vendor to solicitation package distribution list.

3. The General Contractor is responsible for ordering and payment for the full service counters and for coordinating the install Vendor.

FULL SERVICE COUNTERS PRICING

<u>OLD PSIN</u>	<u>NEW PSIN</u>	<u>Baker Part #</u>	<u>DESCRIPTION</u>
NEW BAKER WORKSTATION			
7400 7400BLB	7501-01-W72 For Non-POS & POS Locations	PW511-01	<i>Standard Clerk Workstation (Base Unit Only). Square Post. <u>NOT A COMPLETE</u> Need to order PSIN 7503-01-KPOS (POS KIT) or PSIN 7502-01-KNPOS (NON KIT) with this item depending on local operation requirement. See figure 1.</i>
	7502-01-KNPOS For Non-POS Locations Only	PW534-01	<i>Kit, 5-Drawer w/ 2-Drawer Inserts. Need to order with PSIN 7501-01-W72 (sta clerk workstation base unit). See figure 2.</i>
	7503-01-KPOS For POS Locations Only	PW510-01	<i>Kit, 2-Stamp Drawers w/ 1 insert, Closure Panel. Need to order with PSIN 750 W72 (standard workstation base unit). See figure 3.</i>

<u>OLD PSIN</u>	<u>NEW PSIN</u>		<u>DESCRIPTION</u>
NEW HANDICAP ACCESSIBLE COUNTER OPTIONS			
7460 7400HC32LB 7400HC32	7504-01-HC32 For Non-POS & POS Locations	PW700-01	<i>Accessible Side Counter Add-On, Option "A." 32" Wide, 36" High. <u>NOT A COMPLETE UNIT.</u> Need to order with PSIN 7501-01-W72 (standard workstation) with either PSIN 7503-01-KPOS (POS KIT) or PSIN 7502-01-KNPOS (N KIT). See figure 4.</i>
7461 7400HC84 7400HC84BLB	7505-01-HC84 For Non-POS Locations	PW741-01	<i>Clerk Workstation w/ Accessible Option "B." 84" Wide, 36" High. <u>COMPLETE</u> with 36" Accessible counter. . See figure 5.</i>
	7505-01-HC84POS For POS Locations	PW743-01	<i>Clerk Workstation w/ Accessible Option "B." 84" Wide, 36" High. <u>COMPLETE</u> with 36" Accessible counter. See figure 6.</i>
7462 7400HC72 7400HC32LB	7506-01-HC72 For Non-POS Locations	PW742-01	<i>Clerk Workstation w/ Accessible Option "C." 72" Wide, 36" High. <u>COMPLETE</u> with 24" Accessible counter. See figure 7.</i>
	7506-01-HC72POS For POS Locations	PW744-01	<i>Clerk Workstation w/ Accessible Option "C." 72" Wide, 36" High. <u>COMPLETE</u> with 24" Accessible counter. See figure 8.</i>
	7507-01-HC60 For POS & Non- POS Locations	PW834-01	<i>"Five-Foot" Accesible Clerk Workstation - Option "D." 60" Wide, 36" High. <u>COMPLETE UNIT</u> with 24" HC counter. See figure 9.</i>
	7507-01-W60 For POS & Non- POS Locations	PW835-01	<i>"Five-Foot" Non-Accessible Clerk Workstation - Option "D." 60" Wide, Standard Height. <u>COMPLETE UNIT.</u> See figure 10.</i>

<u>OLD PSIN</u>	<u>NEW PSIN</u>	<u>DESCRIPTION</u>
ELECTRICAL BASE FEED OPTIONS		
		<i>existing electrical junction boxes (see construction documents for electric location):</i>
		1. <i>If a workstation is being ordered for a retrofit application and there is no existing</i>
		2. <i>If a workstation is being ordered for a retrofit application and there is obsolete furniture in place and a new square post unit is being added.</i>
		3. <i>If this is a new installation, there must be one base feed ordered for every workstation.</i>
		REFERENCE DETAIL G5-2-8a
	7417SP	PW529
	7507-01-BFRR	PW549
	7416SP	PW531-01
		Electrical Base Feed (left rear - viewed from customer side)
		Electrical Base Feed (right rear - viewed from customer side)
		Electrical Base Feed (left front - viewed from customer side)

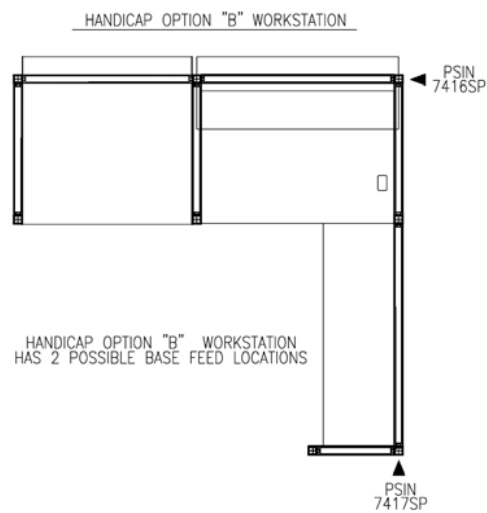
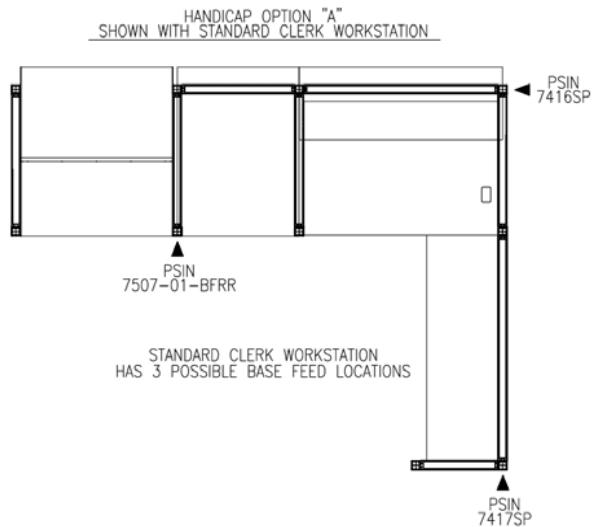

Figure #1

Standard Clerk Workstation Base Unit

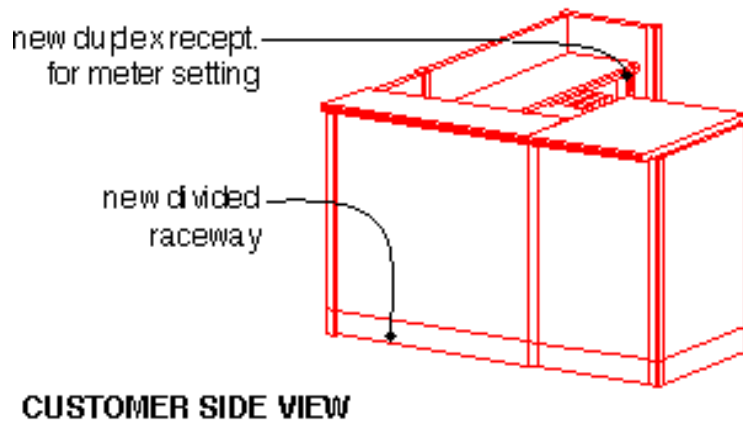
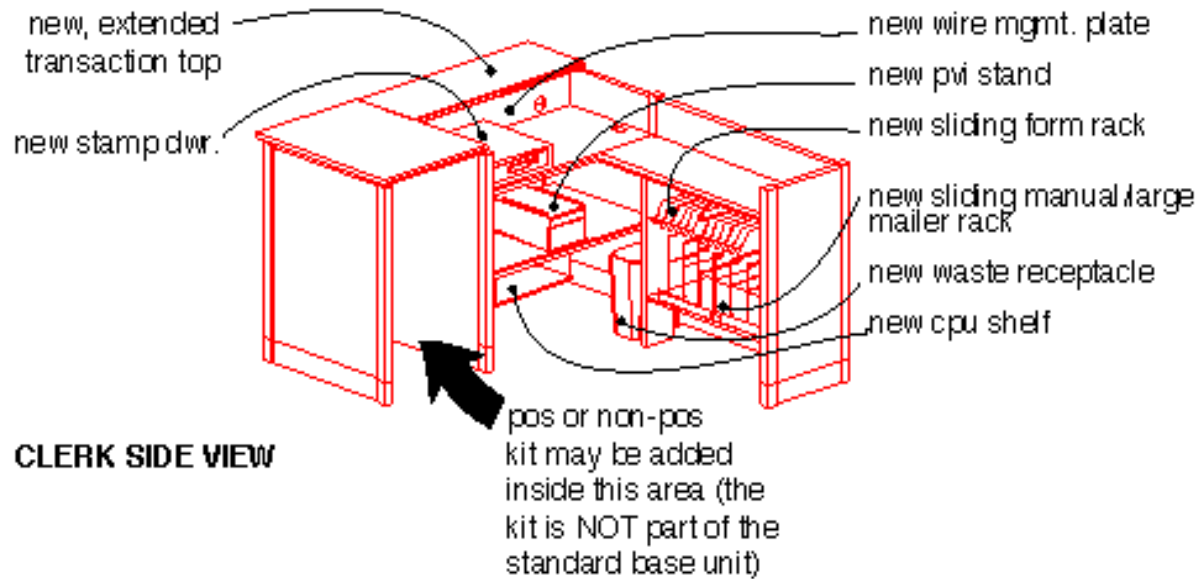
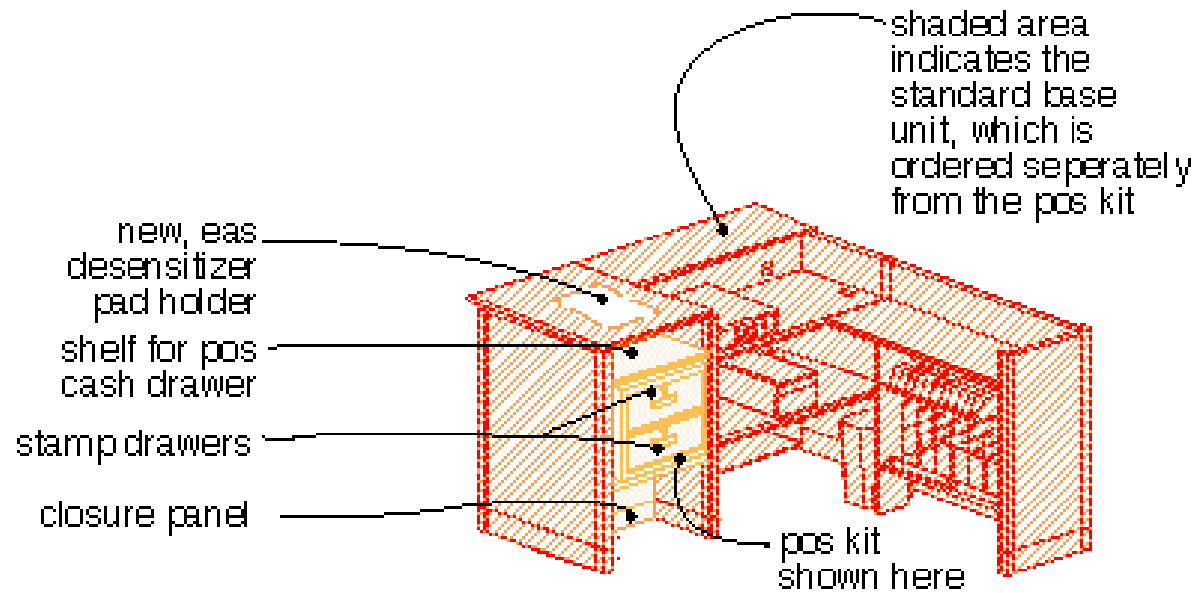
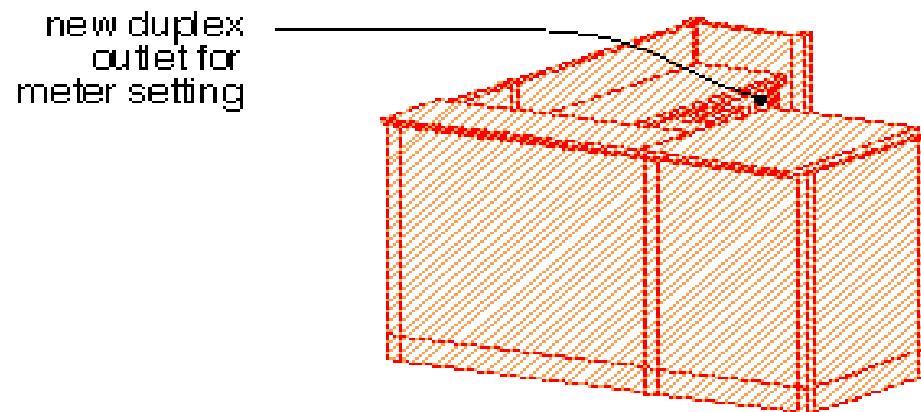

Figure #3

POS Kit



CLERK SIDE VIEW



CUSTOMER SIDE VIEW



SCISSORS LIFT PRICING - GENERAL INFORMATION

Instructions:

1. DIRECT VENDOR:

Advance Lifts, Inc.
701 S. Kirk Road St. Charles IL 60174-3428
Toll Free- 800-843-3625

2. All orders must be placed using Advance Lifts web-based ordering system: <http://www.uspslifts.com>. Contractors must enter their information and the Contractor access code which is 'contractor2004'.

3. The General Contractor is responsible for ordering and payment for the scissors lift.

SCISSORS LIFT PRICING

Model	Capacity	Platform	Low Ht.	Travel	Raised Ht.	HP	Speed	Control	Weight
2500K	5000 lbs.	6' x 8'	10"	58"	68"	5	12 fpm	Push Button	2600 lbs.

Accessories: 36 x 66 split aluminum bridge, audio visual alarm, limit switch, installation package, freight and mechanical installation.

To determine your shipping and installation costs check the State/Zone you're in and then look for your cost.

ST/Zone	ST/Zone	ST/Zone	ST/Zone	ST/Zone	ST/Zone	ST/Zone	ST/Zone	ST/Zone	ST/Zone
AL=2	AK=N/A	AZ=4	AR=2	CA=4	CO=4	CT=2	DE=2	DC=2	FL=3
GA=3	HI=N/A	ID=4	IL=1	IN=1	IA=1	KS=4	KY=3	LA=3	ME=2
MA=2	MD=2	MI=1	MN=1	MO=1	MS=3	MT=4	NE=4	NV=4	NH=2
NJ=2	NM=4	NY=2	NC=3	ND=4	OH=1	OK=4	OR=4	PA=2	RI=2
SC=3	SD=4	TN=3	TX=4	UT=4	VA=2	VT=2	WA=4	WI=1	WV=1
WY=4									

Price Delivered and Installed:

ZONE 1 = \$6265.00
ZONE 2 = \$6495.00
ZONE 3 = \$6440.00
ZONE 4 = \$7265.00

Available Options:

230V/60Hz/1Ph power voltage = \$405.00
Oil immersion heater = \$225.00
Extra hydraulic hose @ \$7.00/LF

Technical:

Contractor must select voltage: (if other than 230V/60Hz/3Ph)
230V/60Hz/1
460V/60Hz/3
OR Other

Notes:

- The above price is subject to a 10% USPS contract price discount if paid within 20 days from date of invoice.
- This is a special USPS contract price so the attached "Terms of Sale to Contractors for USPS Dock Lifts" apply.
- Lifts purchased under this contract and installed in other than USPS facilities will be invoiced at list price, which contractor agrees to pay along with all collection costs.